

WINTEK SEALING INDUSTRIAL CO., Ltd

ADDRESS: No. 53-1, Zingzhung St, Lane 180, Dali City, Taichung County 41263

TEL: 886-4-24952988 FAX: 886-4-24969787

E-Mail: service@wtk-sealing.com.tw

WEBSITE: www.wtk-sealing.com.tw



GM-500 SERIES

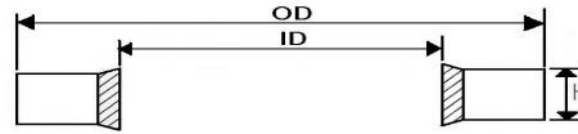

SIZE REF.	ID	OD	H
#001	3.05	6.35	1.2
#002	4.12	7.26	1.2
#003	5.21	8.38	1.2
#004	6.86	13.21	1.2
#005	6.99	13.34	1.2
#006	8.31	13.34	1.2
#007	8.64	14.22	1.2
#008	11.26	18.36	2.0
#009	11.69	19.05	2.0
#010	14.86	22.23	2.0
#011	16.51	25.40	2.0
#012	18.16	25.40	2.5
#013	24.26	33.27	2.5
#014	29.33	36.58	2.5
#015	32.64	41.40	3.2
#016	35.94	44.45	3.2
#017	38.96	47.75	3.2
#018	45.34	57.15	3.2
#019	51.69	63.50	3.2
#020	10.37	15.88	2.0
#021	13.74	20.57	2.0
#022	15.83	22.23	2.0
#023	17.28	23.80	2.0
#024	19.69	26.92	2.5
#025	21.54	28.58	2.5
#026	23.49	31.75	2.5
#027	27.05	34.93	2.5
#028	27.82	38.61	2.5
#029	30.81	38.10	2.5
#030-2.5	33.89	42.80	2.5
#030-3.2	33.89	42.80	3.2
#031	33.89	42.80	2.5
#032-2.5	42.93	52.38	2.5
#032-3.2	42.93	52.38	3.2
#033-2.5	48.44	58.60	2.5

SIZE REF.	ID	OD	H
#033-3.2	48.44	58.60	3.2
#034	54.89	69.85	3.2
#035	58.04	70.36	3.2
#036-2.5	60.58	73.03	2.5
#036-3.2	60.58	73.03	3.2
#037	64.39	77.72	3.2
#038	66.68	79.50	3.2
#039	76.08	90.17	3.2
#201	4.10	7.20	1.0
#202	4.50	7.00	1.0
#203	5.70	9.00	1.0
#204	5.70	10.00	1.0
#205	6.20	9.20	1.0
#206	6.70	10.00	1.0
#207	6.70	11.00	1.0
#208	6.70	11.00	2.5
#209	7.10	12.00	1.0
#210	7.30	10.20	1.0
#211	8.50	13.40	1.0
#212	8.70	13.00	1.0
#213	8.70	14.00	1.0
#214	8.70	16.00	1.0
#215	9.30	13.30	1.0
#216	10.35	16.00	2.0
#217	10.70	16.00	1.5
#218	10.70	18.00	1.5
#219	11.40	16.30	1.5
#220	11.80	18.50	1.5
#221	11.80	19.10	1.5
#222	12.70	18.00	1.5
#223	12.70	20.00	1.5
#224	13.70	20.00	1.5
#225	13.70	22.00	1.5
#226	14.00	18.70	1.5
#227	14.70	22.00	1.5

WINTEK SEALING INDUSTRIAL CO., Ltd

ADDRESS: No. 53-1, Zingzhung St, Lane 180, Dali City, Taichung County 41263

TEL: 886-4-24952988 FAX: 886-4-24969787

E-Mail: service@wtk-sealing.com.tw

WEBSITE: www.wtk-sealing.com.tw



GM-500 SERIES

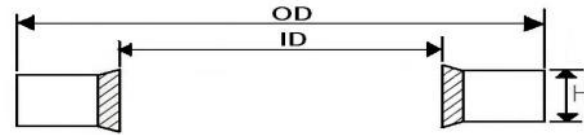

SIZE REF.	ID	OD	H
#228	16.00	22.70	1.5
#229	16.70	24.00	1.5
#230	17.40	24.00	1.5
#231	18.00	24.70	1.5
#232	18.70	26.00	1.5
#233	20.70	28.00	1.5
#234	21.50	28.70	2.5
#235	22.50	28.00	1.5
#236	22.70	30.00	2.0
#237	22.70	30.00	3.0
#238	24.70	32.00	2.0
#239	26.70	35.00	2.0
#240	27.20	36.00	2.0
#241	28.70	37.00	2.0
#242	31.00	39.00	2.0
#243	33.70	42.00	2.0
#244	34.30	43.00	2.0
#245	36.70	46.00	2.0
#246	40.00	51.00	2.5
#247	42.70	53.00	3.0
#248	48.70	59.00	3.0
#249	52.00	60.00	3.0
#250	53.30	64.50	3.0
#251	60.70	73.00	3.0
#252	68.60	79.50	3.5
#253	76.08	90.30	3.5
#254	89.09	101.48	3.2
#255	127.00	143.67	5.0
#301	3.60	7.50	1.0
#302	4.60	9.00	1.0
#303	5.60	10.00	1.0
#304	6.60	11.00	1.0
#305	6.85	13.27	1.3
#306	7.00	11.40	1.0
#307	8.60	13.00	1.0

SIZE REF.	ID	OD	H
#310	10.70	17.00	1.5
#312	11.80	18.10	1.5
#313	12.70	19.00	1.5
#315	13.80	20.10	1.5
#316	14.70	21.00	1.5
#317	16.70	23.00	1.5
#320	18.70	27.00	2.0
#321	20.70	29.00	2.0
#323	21.70	30.00	2.0
#324	22.70	31.00	2.0
#325	23.70	32.00	2.0
#326	24.70	33.00	2.0
#327	27.00	35.30	2.0
#328	27.70	36.00	2.0
#329	28.60	36.00	2.0
#330	29.20	37.50	2.0
#331	30.70	39.00	2.0
#332	33.70	42.00	2.0
#333	37.00	48.00	2.5
#334	40.00	51.00	2.5
#335	43.00	54.00	2.5
#336	46.00	57.00	2.5
#337	49.00	60.00	2.5
#510	10.40	14.70	1.2
#511	13.85	18.70	1.2
#512	17.35	22.70	1.2
#513	21.65	26.70	1.2
#514	27.30	32.50	1.2
#515	34.20	39.50	2.0
#516	42.80	49.50	2.0
#517	48.70	55.50	2.0
#518	60.50	68.50	2.0
#519	8.30	12.70	1.2